

# DEKOR® Soffit Installation Instructions

DEKOR® Soffit LED Lights are bright spot or floodlights in a tiny package. Use these lights to accent walls, highlight architectural features, or add safety to the exterior of your home. These versatile lights can be used indoors and out. They are waterproof, very durable, and backed by a Limited Lifetime warranty.

Soffit Spot Light

Soffit Flood Light

Dimensions

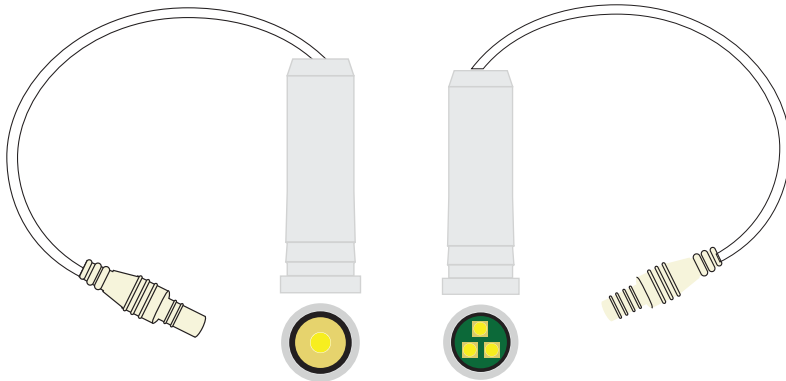

Example of the light Usage

**TOOLS NEEDED**

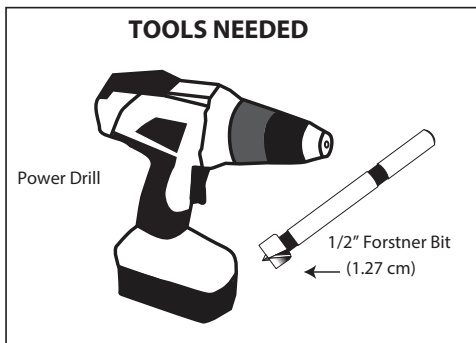

» 20', 5', 10', 20', 40', and 60' male to male connection/extension wires and connectors sold separately.

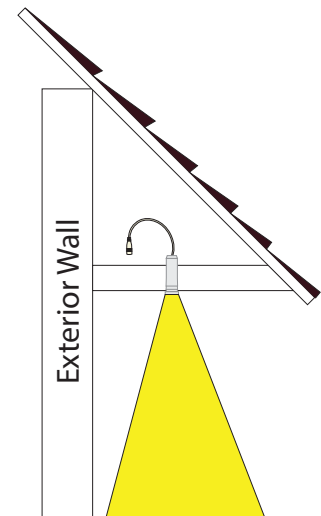

**HELPFUL TIPS**

- » Follow the appropriate building and electrical codes when installing all DEKOR® lighting products.
- » Leave wire slack to make fixture terminations.
- » It is recommended to determine placement of lighting under dark conditions prior to drilling/installation.
- » DO NOT use more than one transformer on each circuit.
- » To ensure all components are in working condition it is recommended to have power source attached and on when installing lights.

**CAUTION:**

When making a connection between a Plug-N-Play connector or a splitter, observe the polarity key to make the proper connection. must match up. **DO NOT** force the connectors together. Plug-N-Play connectors are waterproof, but all used ports must be cap with the provided caps or dielectric grease.

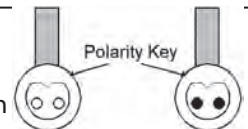

# DEKOR® Soffit Installation Instructions

## General Information

- » ALWAYS check local codes before beginning your project. USE DEKOR® TRANSFORMERS for the Limited Lifetime warranty. Using any other type of transformer the lights will have a 3-year warranty.

TRANSFORMER CAPACITY BY TYPE		
Example	5A Transformer EZ Max Transformer	2.5A Transformer EZ Transformer
Soffit Flood Light	14	8
Soffit Spot Light	16	10

The list above is for maximum number of each individual types of lights. If mixing and matching lighting reference the transformer calculator at [www.dekorlighting.com](http://www.dekorlighting.com).

## Planning:

**NOTE:** Prior to installation, find locations for your power supply, timer, and dimmer. These need to be accessible. A GFCI outlet is required to help prevent damage to lights due to electrical incidents.

1. Plug the timer into a GFCI outlet located in a dry area.
2. You must install the timer vertically with the receptacle facing down. The timer and transformer must be installed as per local/state and federal water safety regulations.

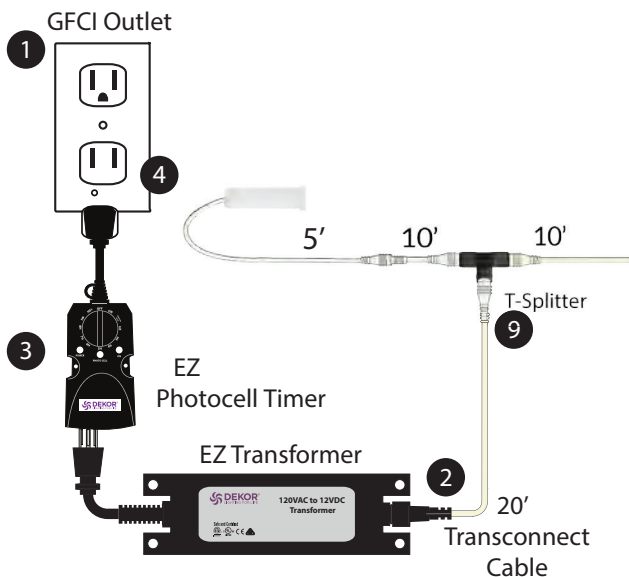

## SOFFIT LED LIGHTING INSTALLATION

Live wiring installation (install with connected/activated lights) is recommended to ensure complete connection and functionality.

1. Determine location of power source (external/interior outlet).
2. Connect 20' transconnect cable to EZ transformer.
3. Plug EZ transformer into timer (if applicable).
4. Plug timer into power source (external/interior outlet).
5. Turn the photocell timer to ON.
6. It is very important that you determine location for your soffit lights prior to drilling holes. Test lights in the on position.

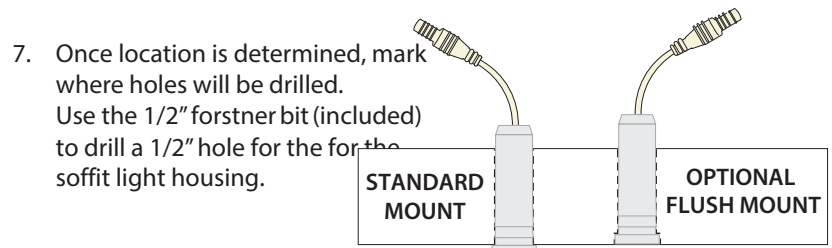

7. Once location is determined, mark where holes will be drilled. Use the 1/2" forstner bit (included) to drill a 1/2" hole for the soffit light housing.

8. If a FLUSH mount is desired, use a 5/8" forstner bit (not included) and drill a counter sink hole 1/8" deep, then use the 1/2" forstner bit to completely drill through the material.

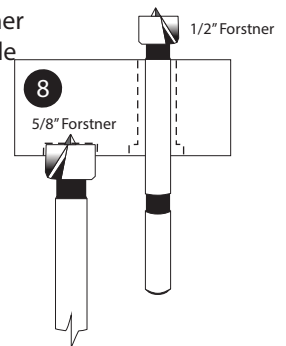

9. When all holes are drilled, connect the 20' transconnect cable to the closest light.

10. Push the LED Soffit light into hole. **DO NOT USE A HAMMER.** Using a hammer to insert the light will damage lens and/or LED.

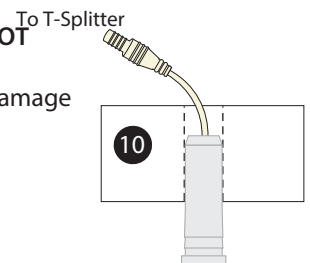

11. Connect next Soffit light using Plugh-N-Play 6-port or T-Splitter.
12. Repeat steps above for each additional light.